

# PLANNING APPLICATION

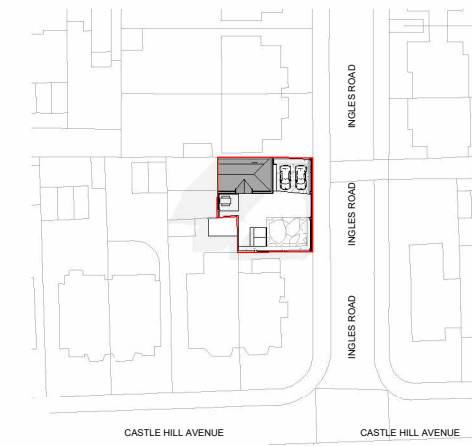

**1 BLOCK PLAN**  
1 : 200

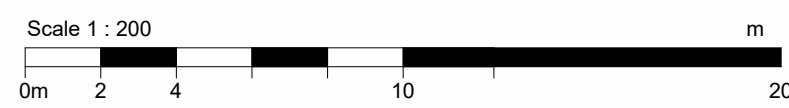

**2 LOCATION PLAN**  
1 : 1250

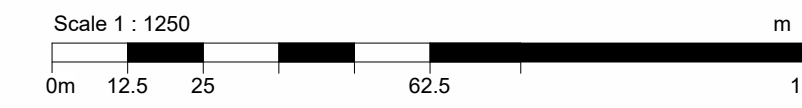

Produced on 24 October 2025 from the Ordnance Survey National Geographic Database and incorporating surveyed revision available at this date.  
This map shows the area bounded by  
622199 135860,622299 135860, 622299 13596, 622199 135960, 622199 135860  
Crown copyright and database rights 2025 OS 100054135. Supplied by copla ltd trading as UKPlanningMaps.com a licensed Ordnance Survey partner (OS 100054135).  
Data license expired 24 October 2026. Unique plan reference: v1f/1330557/1783371

— BOUNDARY LINE

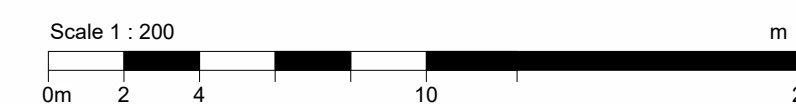

**General notes**

Subject to all statutory approvals.

Dimensions in millimetres unless stated otherwise.

Dimensions govern. Do not scale off drawing. All dimensions to be verified on site before proceeding.

All discrepancies to be notified in writing to the client and to Profile Architects Ltd.

All perspective views are indicative for illustrative purposes only.

© Profile Architects Ltd 2026

REV	Date	Reason For Issue	Chk
1	14.10.25	EXISTING DRAWINGS	
2	05.01.25	AMENDED BLOCK PLAN	

**PLANNING APPLICATION**

**PROFILE**

F1b Glassworks, Mill Bay  
Folkestone  
Kent CT20 1JG  
01303 767 200  
studio@profilechitects.com  
profilearchitects.com

**Client**

Mrs Holly Conville  
12 Ingles Road, Folkestone  
CT20 2SN

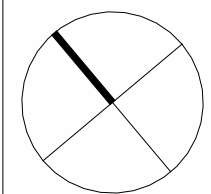

**Project**

Ingles Road, Folkestone

**Drawing Title**

Location & Block Plan  
Existing

**Scale at A1**      **Date**

As indicated      14.10.25

**Project No.**      **Rev No.**

584      2

**Drawing No.**

P0500